

# INSTRUCTION MANUAL

## Nori

Bed frame

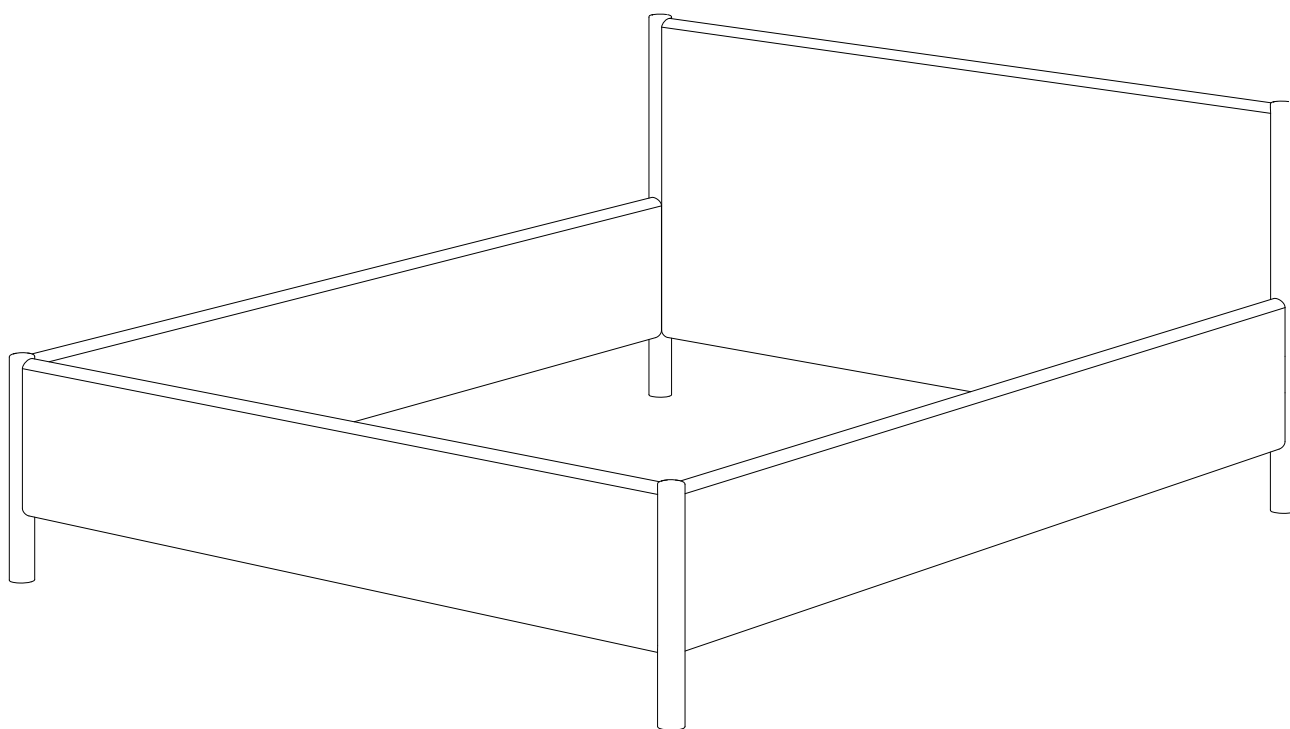

Parts

Fittings



A x 18



B x 18



C x 6

Frame



D x 2

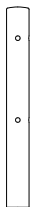

E x 2



F x 1



G x 1

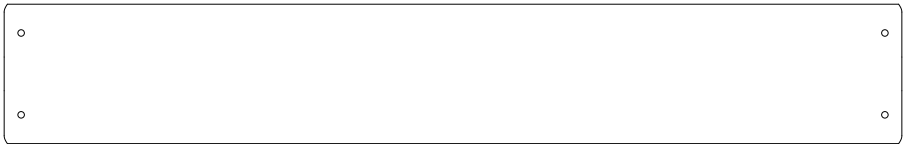

H x 2

1

Parts	
A x 8	
E x 2	

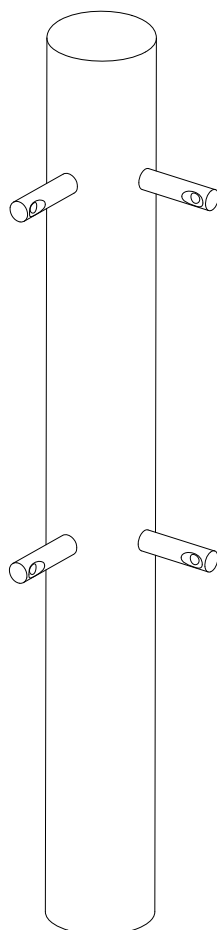
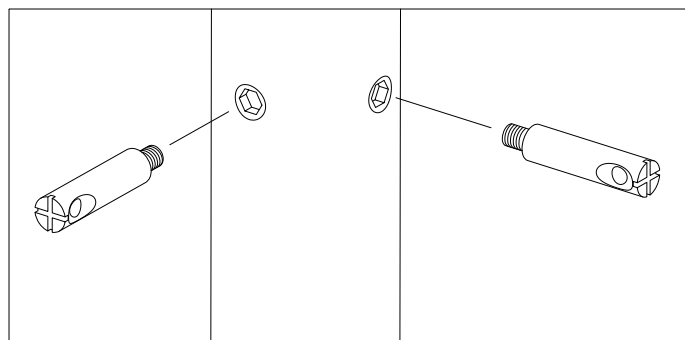

2

Parts

A x 10

D x 2

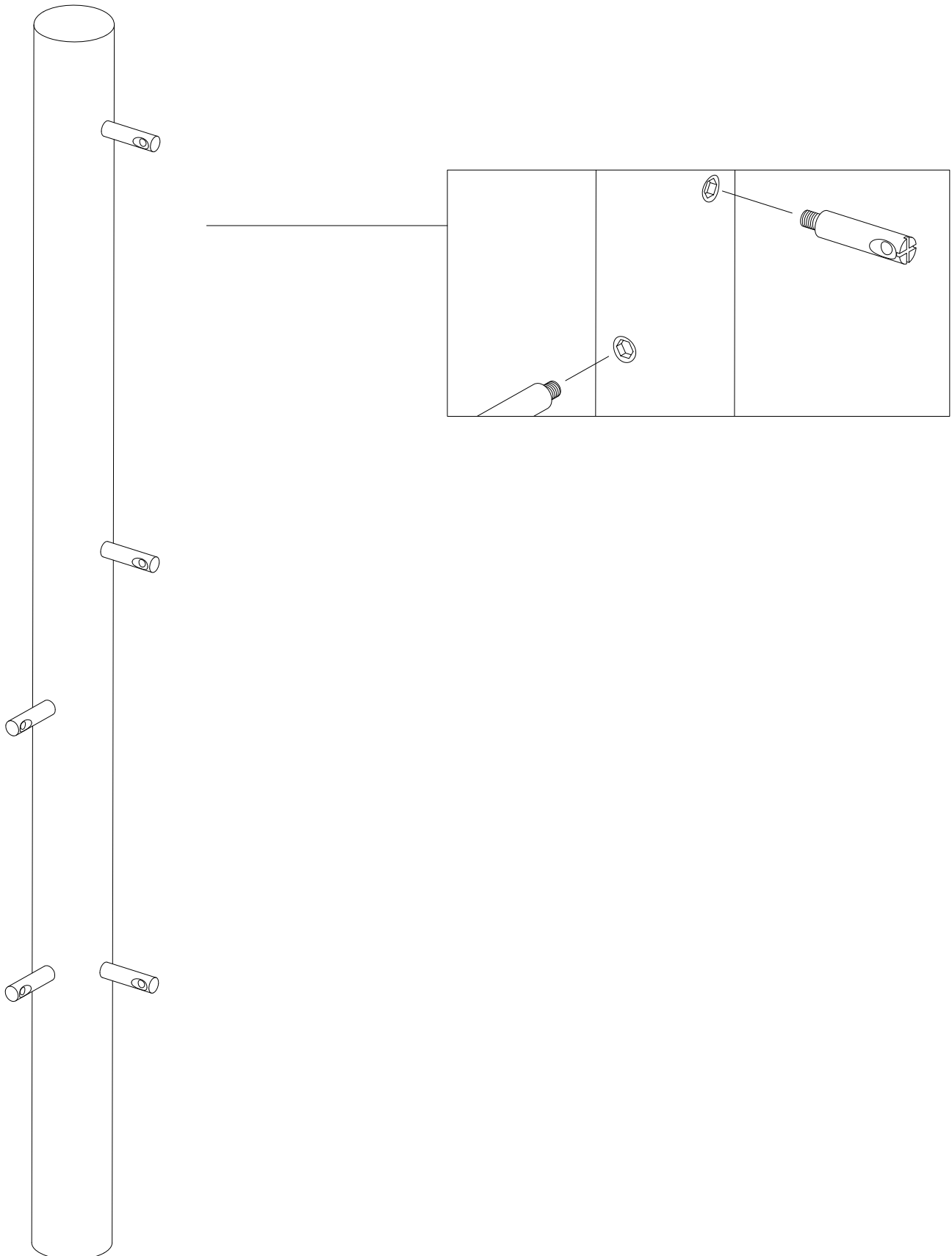

3

Parts	
B x 4	
F x 1	

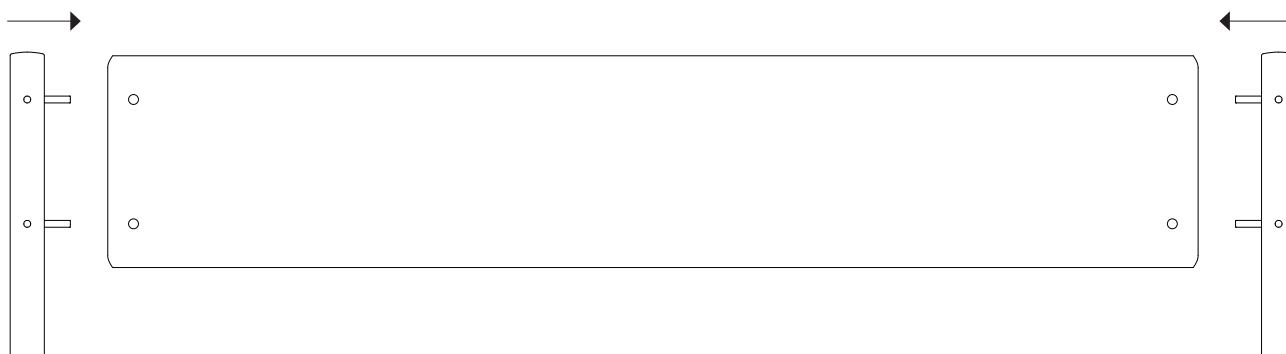

See next page →

3.1

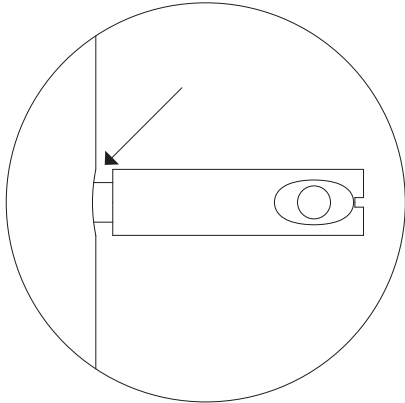

Adjust bracket

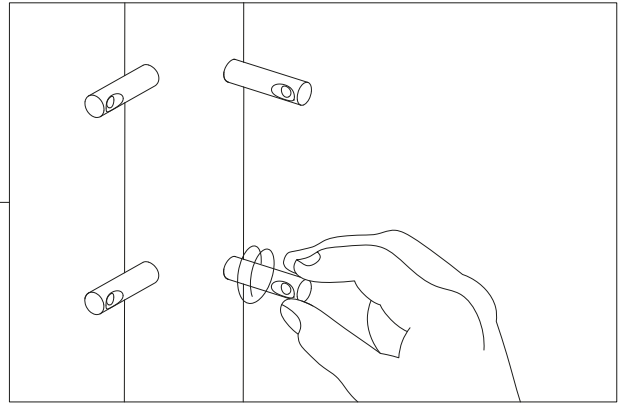

3.2

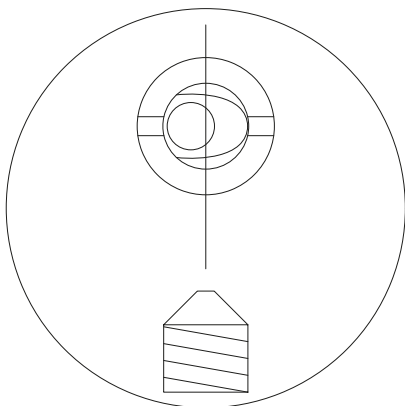

Screw & brackets has to be offcenter to create a tight fit

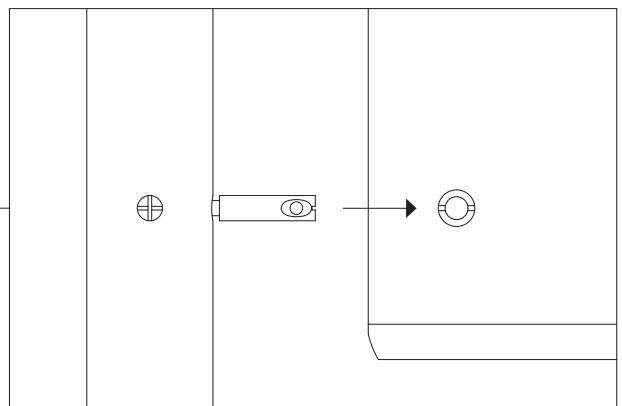

3.3

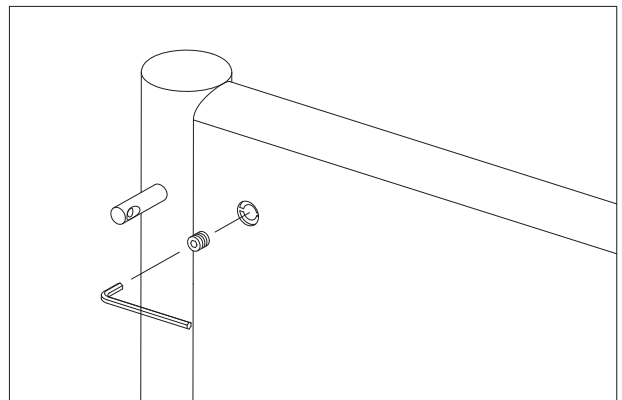

Parts	
B x 6	
C x 6	
G x 1	



See next page →

4.1

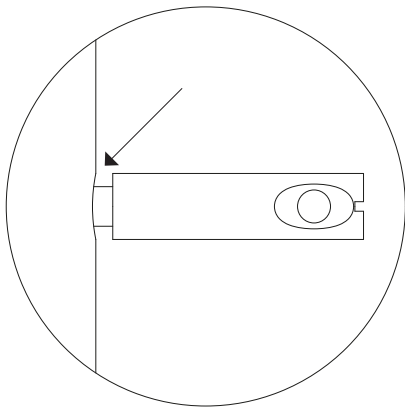

Adjust bracket

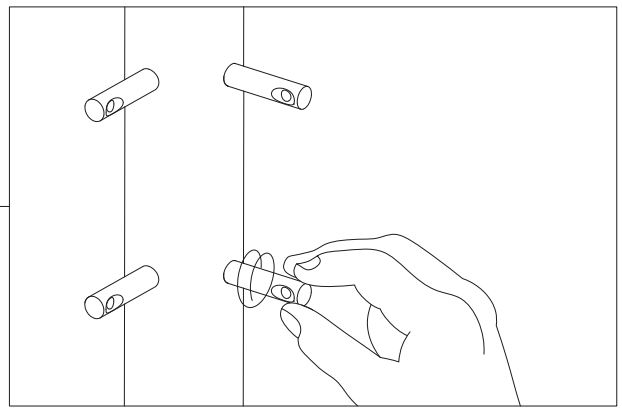

4.2

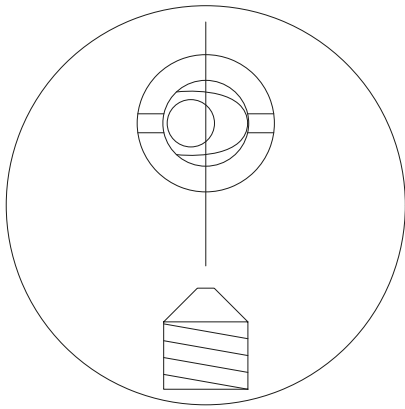

Screw & brackets has to be offcenter to create a tight fit

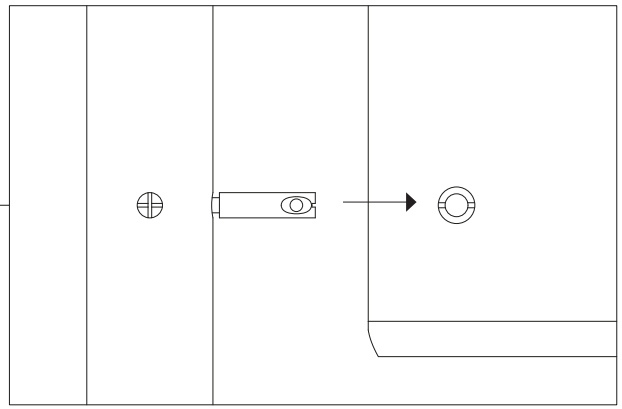

4.3

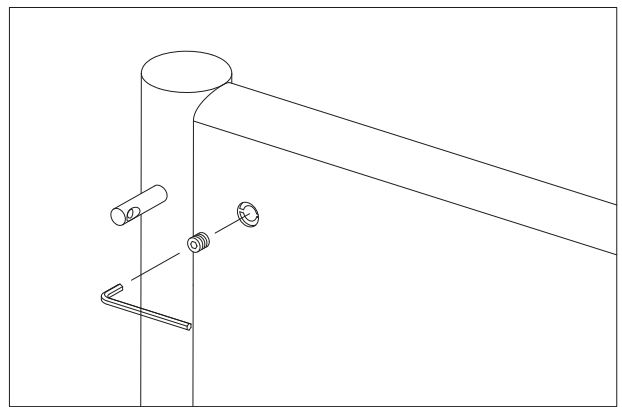

4.4

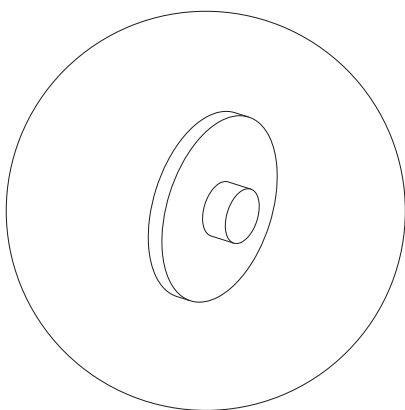

x 6

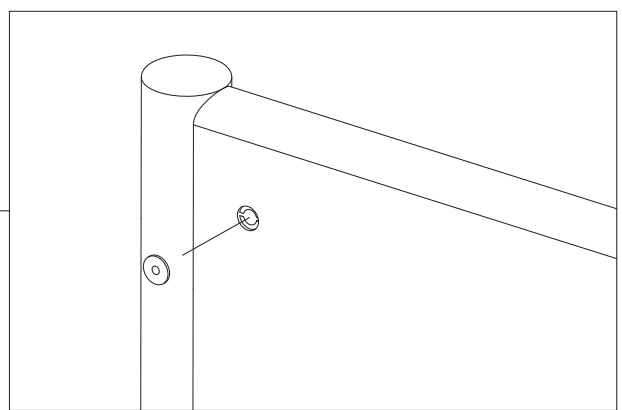

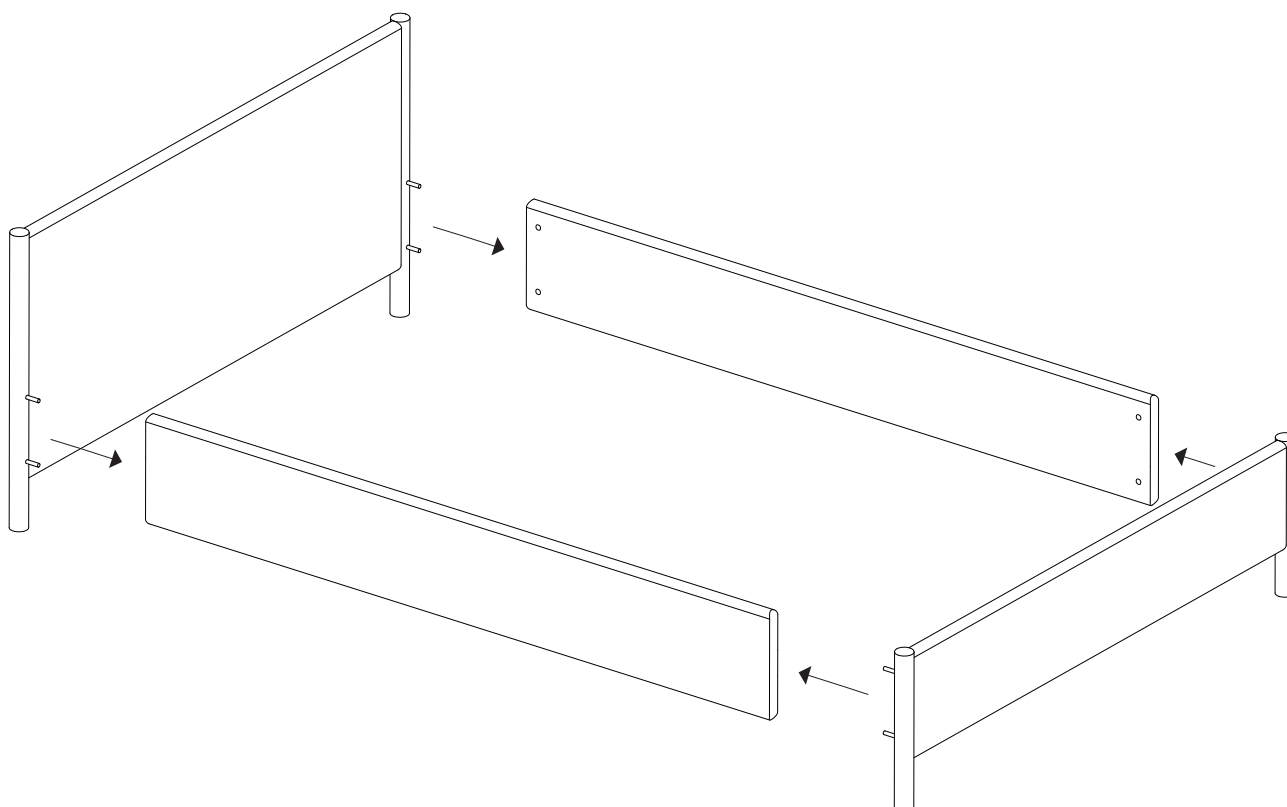

**See next page**

5.1

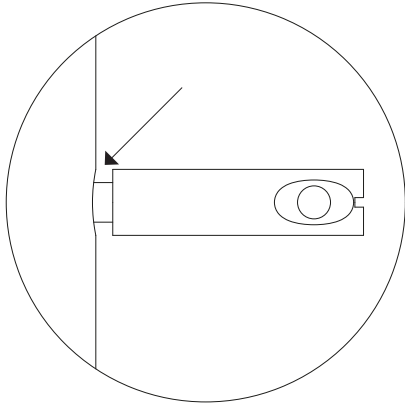

Adjust bracket

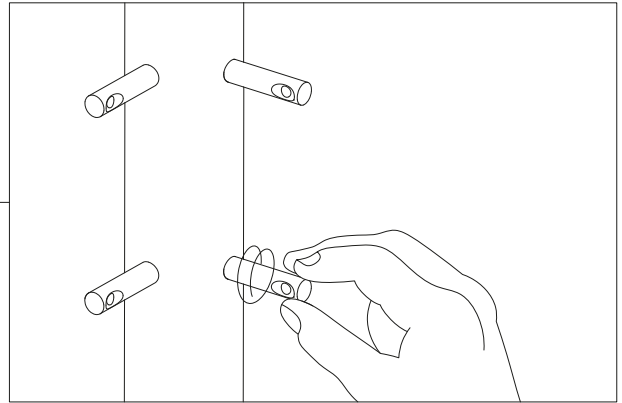

5.2

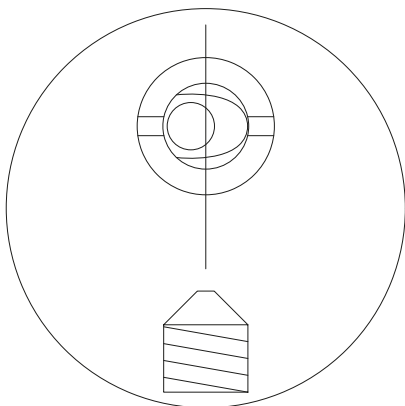

Screw & brackets has to be offcenter to create a tight fit

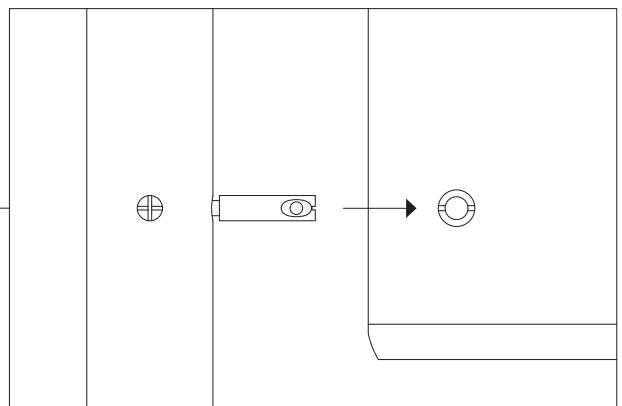

5.3

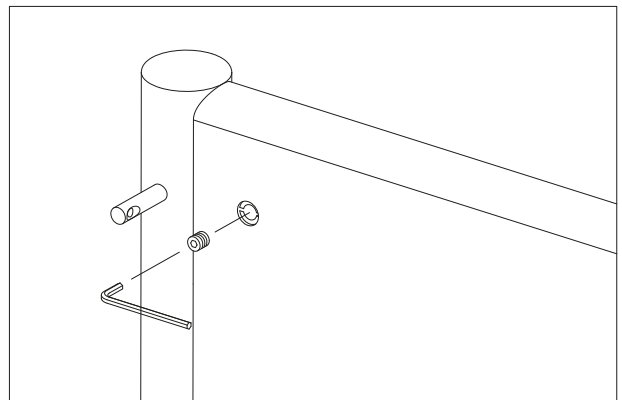

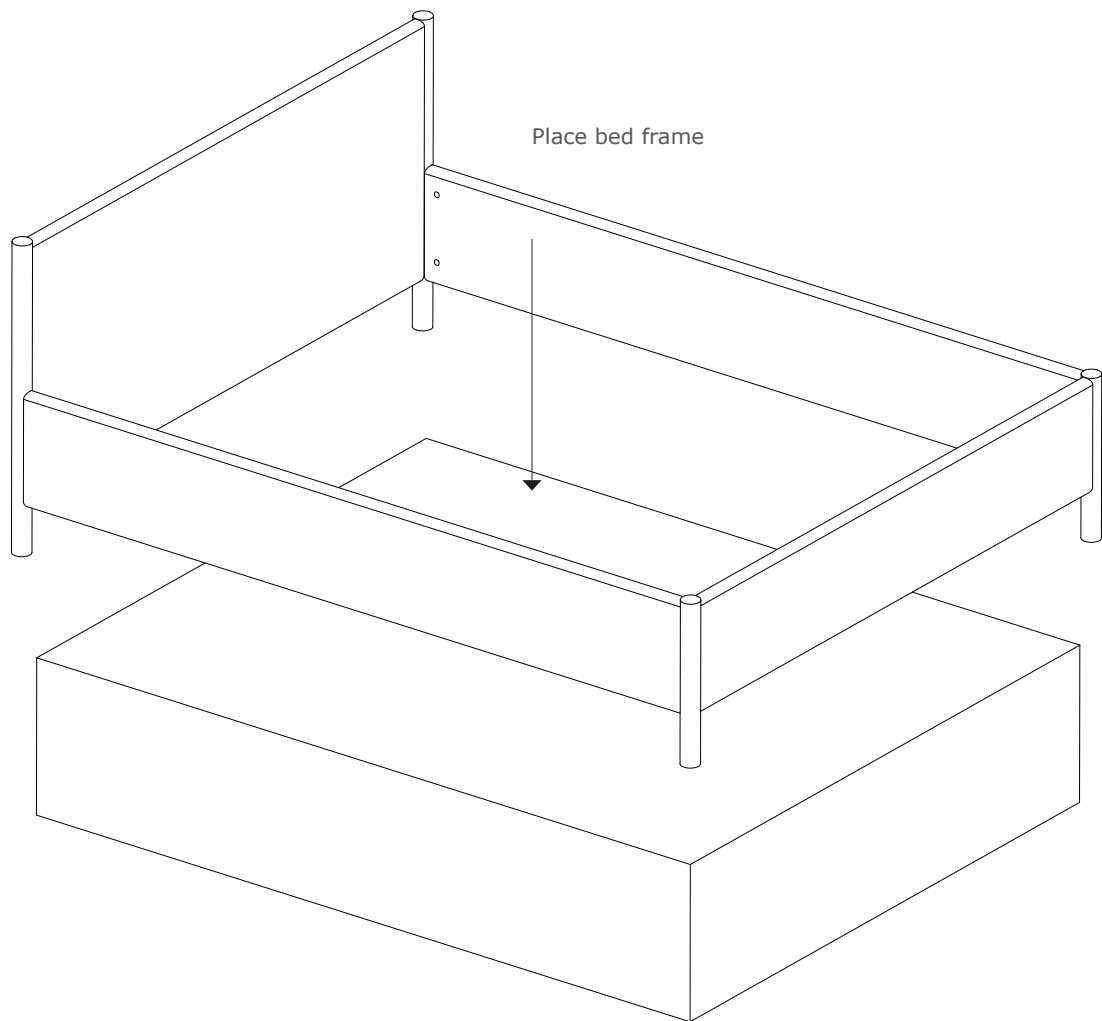



[www.akva.com](http://www.akva.com)